



SMD Shielded Power Inductor Size 1280



- Low loss realized with low DCR.
- High performance realized by metal dust core.
Ultra low buzz noise, due to composite construction.
- 100% Lead(Pb)-Free and RoHS compliant.
- AEC-Q200 qualified
- Operating temperature: -50 to +150 °C (including self-temperature rise)
- Quantity: 500PCS

- Headlamps, tail lamps and interior lighting
- HVAC
- Doors, window lift and seat control
- Audio subsystem
- Digital instrument cluster
- In-Vehicle Infotainment and navigation
- SEPIC circuit

Dimensions: [mm]

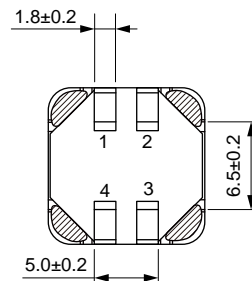
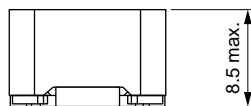

Land Patterns: [mm]

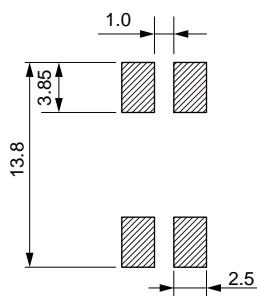

Schematic:

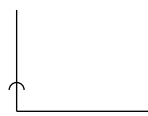
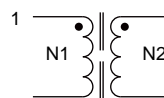

Series

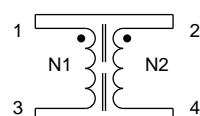

Parallel



Electrical Properties:

Part No	Inductance @ 100KHz/0.1V (μ H)	Tolerance	Temperature Rise Current Typ. (A)		DC Resistance Max. (m)	Hi-POT

Typical Electrical Characteristics:



Soldering Reflow:

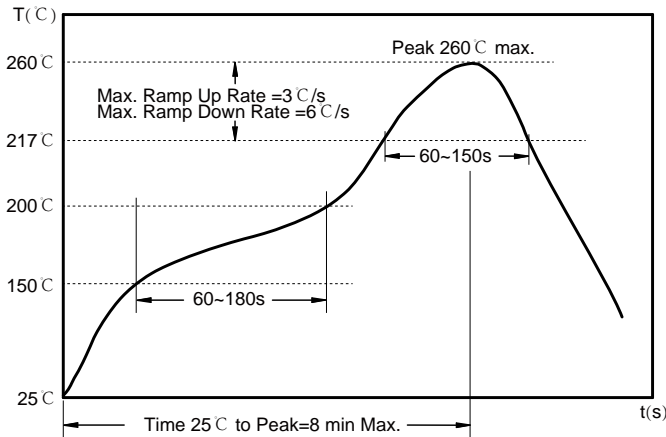

Preheat condition: 150 ~200°C / 60~180 sec.

Allowed time above 217°C : 60~150 sec.

Max temperature: 260°C .

Max time at max temperature: 5 sec.

Allowed Reflow time: 3x max.

Packaging Information:

Tape Dimension :

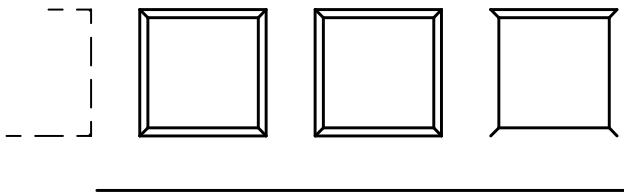

Series	A0 (mm)	B0 (mm)	D (mm)	P0 (mm)	P1 (mm)	W (mm)	K0 (mm)	E (mm)	T (mm)
SDDA1280	12.5±0.1	12.5±0.1	1.5±0.1	4.0±0.1	20.0±0.1	24.0±0.3	8.4±0.1	1.75±0.1	0.50±0.05

Peel force of top cover tape:

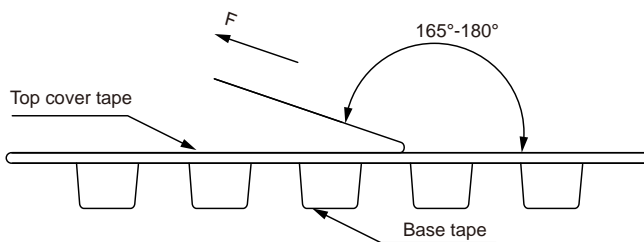

The peel force of top cover tape shall be between 0.1 to 1.3 N



Reel Dimension: [mm]

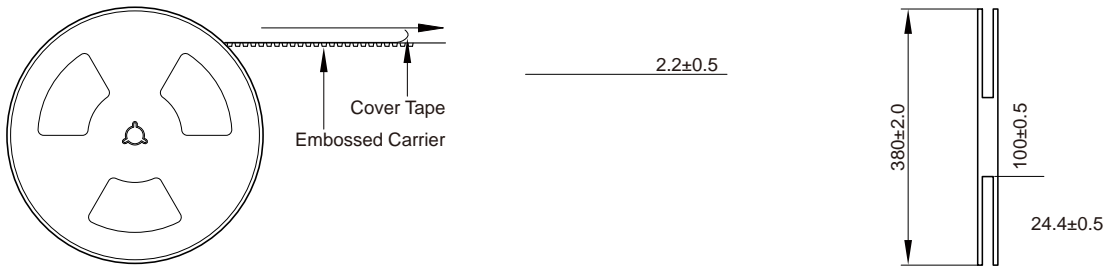

Packaging Quantity:

500 Pcs/Reel

2 Reel /Inner box(1000 Pcs)